

Stavex® BS04



English	Français	Deutsch	Italiano	Español
120° Countersunk head	120° Tête fraisée	120° Senkkopf	120° Testa svasata	120° Cabeza avellanada
Body: Low carbon steel*	Corps: Acier bas carbone*	Hülse: Stahl*	Corpo: Acciaio a basso tenore di carbonio*	Cuerpo: Acero bajo en carbono*
Zinc plated	Revêtement zingué	Verzinkt	Zincato	Zincado
Stem: Low carbon steel**	Tige: Acier bas carbone**	Dorn: Stahl**	Gambo: Acciaio a basso tenore di carbonio**	Vástago: Acero bajo en carbono**
Zinc plated	Revêtement zingué	Verzinkt	Zincato	Zincado

*: BS3111 Type 0, SAE 1008, DIN 1654, QSt 34-3

** : BS3111 Type 0, SAE 1010/1015/1018/1022, DIN 17210, Cq10 / DIN 1654 Cq10/Cq15/Cq22

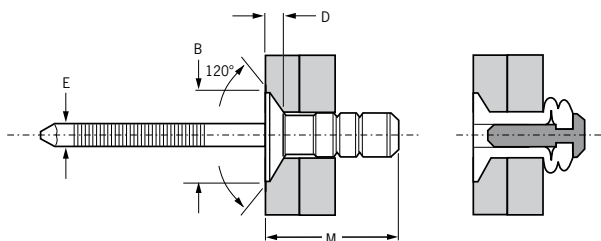

Ø					M	B	D	E			Part No/ref
nom.	min.	max.	min.	max.	max.	max.	max.	max.	lbf min. ¹⁾	lbf min. ¹⁾	
1/8" (3.2 mm)	.039	.236	.129	.134	.55	.232	.039	.084	202	263	0BS04-00414
3/16" (4.8 mm)	.093	.250	.192	.196	.54	.351	.055	.118	450	650	0BS04-00614
	.165	.250			.54						0BS04-C0614
	.093	.375			.67						0BS04-00618
	.250	.500			.79						0BS04-00622

all dimensions in inches / en pouces / alle Maße in Zoll / in pollici / en pulgadas

1) typical values / valeurs moyennes / typische Werte / Valori tipici / resistencias máximas recomendadas



Avdel®

An Acument™ Global Technologies Company

www.avdel-global.com

© 2007 Acument Intellectual Properties, LLC

Stavex® is a trademark of Avdel UK Limited

05.2007

Data shown is subject to change without prior notice as a result of continuous product development and improvement policy.
Your local Avdel representative is at your disposal should you need to confirm latest information.